

## Installation Clearances

### Panel to Panel Clearances & Cutout Clearances

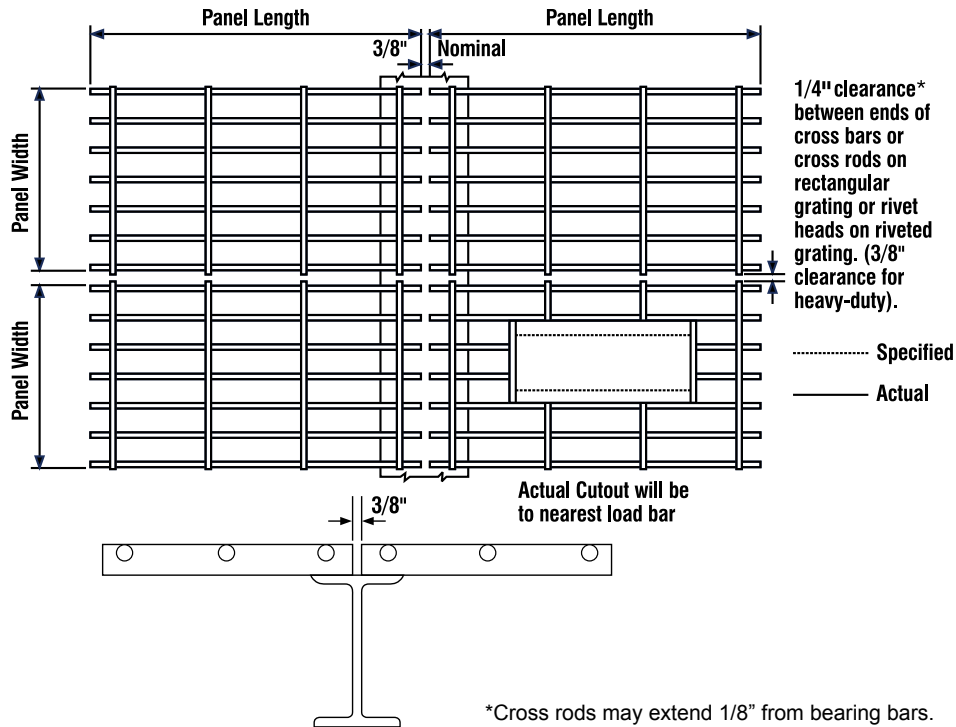

### Support Clearances

\*1/4" is recommended but dimension may vary due to bearing bar spacing. Dimension should not exceed bearing bar spacing.

#### I-Beam and Angle Curb

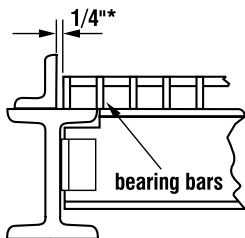

#### I-Beam and Kickplate

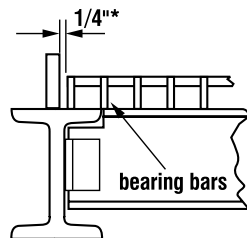

#### I-Beam and Handrail

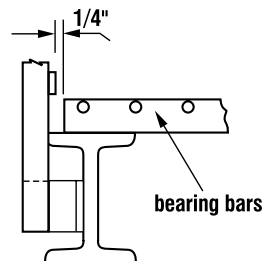

#### I-Beam

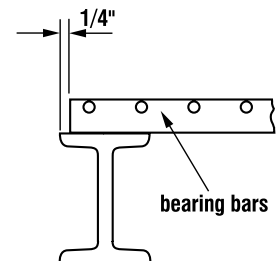

#### Channel Toed Out

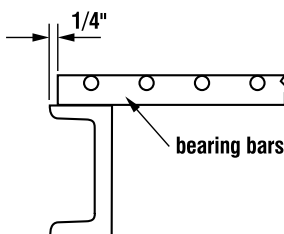

#### Channel Toed In

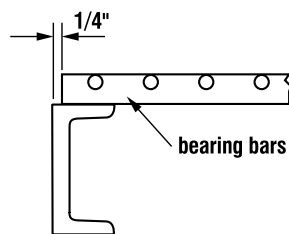

#### Angle in Concrete

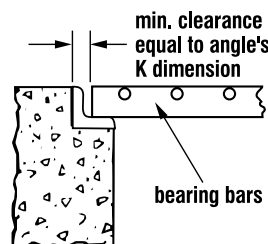

#### Concrete

